

## Hydewa Protect®

Hydewa GmbH  
Hydewaplatz 1-3  
95466 Weidenberg

Technical Data Sheet  
(01.06.2025 Rev 01)



### Description

Hydewa Protect® - The robust and hygienic collision protection with glass fiber technology. Maximum protection, minimum maintenance. Manufactured from high-quality glass fiber-reinforced plastic Glasbord® with an ultra-strong, extremely resilient epoxy resin mortar core, Hydewa Protect® offers extreme resistance to impact, abrasion and corrosion - ideal for industrial and logistics applications in the food and pharmaceutical sectors for protection against all types of transport racks, manual pallet trucks, electric industrial trucks and forklift trucks.

### Technical Data

Properties	Value
Material structure	Glasbord® (Thickness 3mm) Epoxy resin mortar T(hickness 44mm)
Flexural strength	14 N/mm <sup>2</sup>
Compressive strength	53 N/mm <sup>2</sup>
Temperature resistance	-25°C until + 55°C
Weight	app. 42 kg
Dimensions (L x W x H)	1182 x 50 x 425 mm
Quantity per Euro pallet	17 Pieces/ app. 20,23 lfm
Manufacturing tolerances	± 1 mm in each direction
Rear	Stainless steel sheet 0,8 mm
Sealing	Circumferential groove for sealant joint
Chemical resistance	yes (see chemical resistance Glasbord®)
Solvent-free	yes
System compatibility	Hydewa Sandwichsystems
Load specification	Deflection of max. 10 mm with a point load in the center of the field of approx. 1200 kg

## Technical options

- Straight floor connection (floor joint)
- Notch for coving, tile base, hollow notch, etc.
- according to customer requirements
- Prefabricated outside corner
- Simple internal corner
- Optional transverse force shoe made of stainless steel

## Technical drawings

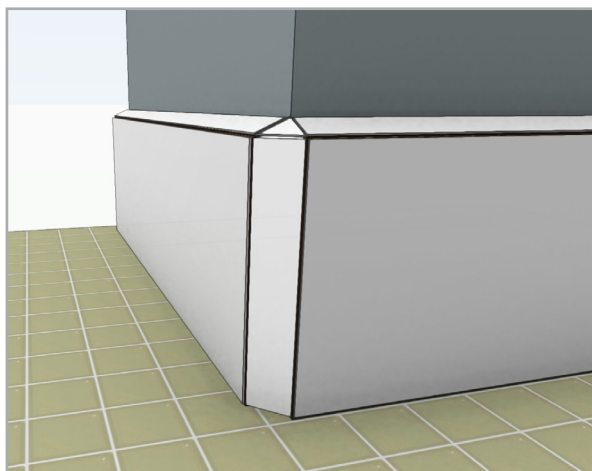
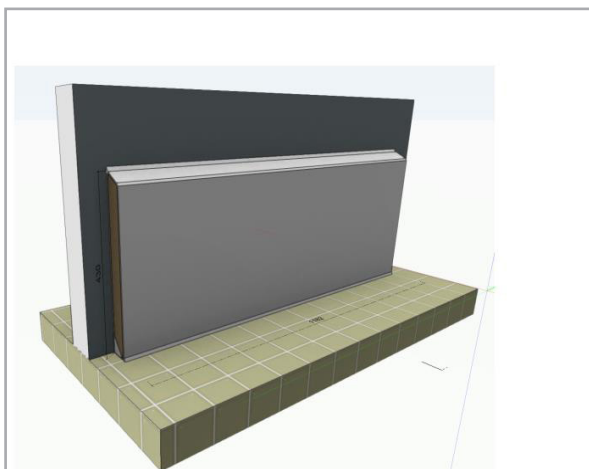

Outside corner Hydewa Protect® (without jointing)

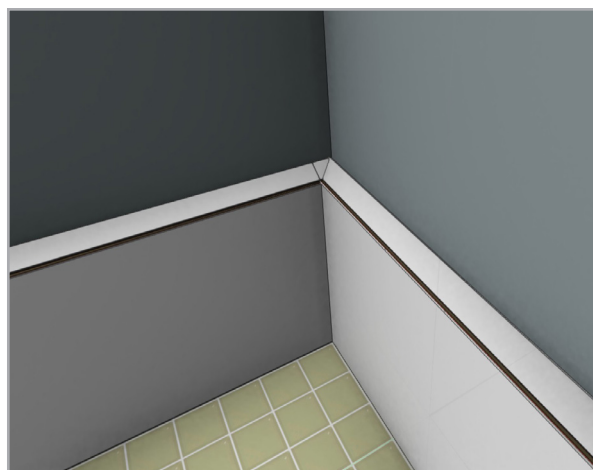

Inside corner Hydewa Protect® (without jointing)

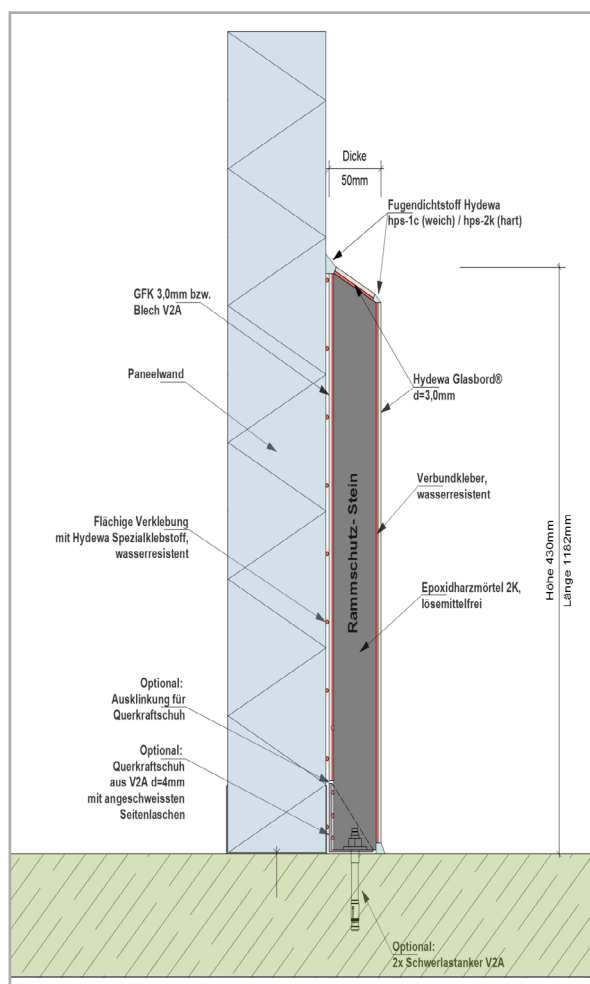

Cut-out Hydewa Protect®

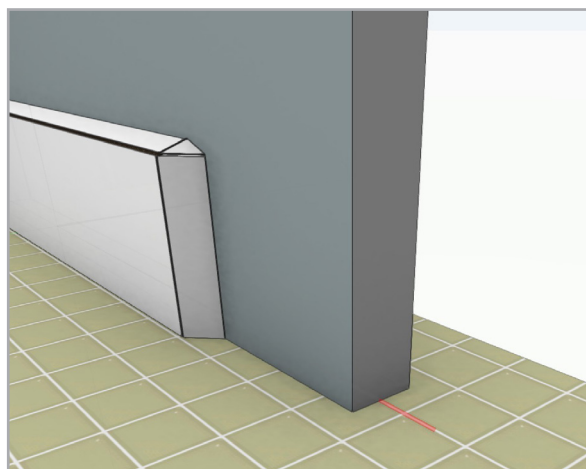

Outside corner Hydewa Protect® for open end (without jointing)

## Possible applications

- Production and hygiene areas (food industry)
- Logistics and goods handling halls
- Warehouses
- Pharmaceutical industry
- Clean room areas
- Commercial kitchens

## Properties

- Maximum resistance due to very high flexural strength
- Hygienic, easy-care surfaces
- Moisture and chemical resistant
- Can be repaired and replaced
- Quick and easy installation
- Easy to cut
- Ideal for retrofitting during renovation work
- Durable and low-maintenance
- Hard and soft grouting possible
- Precise protection of all types of panel walls
- Space-saving due to low installation depth
- Perfect system supplement for Hydewa Glasbord® / FRP walls

## Production, development and sales

In order to provide you, our customer, with consistently high quality, we are constantly developing and improving our products and our production facility.

If you have any questions or suggestions regarding our products, please contact:

Hydewa GmbH, Hydewaplatz 1-3, 95466 Weidenberg

## Certificates Surface Glasbord®



Klassifiziert nach  
DIN EN 13501-1



low chemical emis-  
sion



LFGB § 31  
indirekter Kontakt  
mit Lebensmitteln

